

# XA23



## eXtreme Air 2x3 MicroAir® Installation and Operation Manual

### **IMPORTANT:**

This manual contains specific cautionary statements relative to worker safety. Read this manual thoroughly and follow as directed. It is impossible to list all the hazards of dust control equipment. All persons involved with the equipment or systems should be instructed how to operate in a safe manner.

## CAUTIONS:

Avoid mixing combustible materials, such as buffing lint, paper, and wood with dust generated from grinding ferrous metals due to the potential fire hazard caused by sparks in the table.

Under no conditions should cigarettes or any other burning object be put into the table.

All users of MicroAir dust collection equipment should comply with all National and Local Fire Codes and/or other appropriate codes when determining the location and operation of dust control equipment.

This table is not suited for applications where explosion potential is present. Consult the Factory to determine if there is a risk.

## SPECIFICATIONS:

INPUT VOLTAGE:  
120V 60Hz 1 Phase

MAXIMUM CURRENT:  
1/2HP 120V: 7.5Amps

MOTOR:  
1/2HP 1 Phase 1740 RPM TEFC

OVERALL DIMENSIONS:  
Base Table: 37" H x 36" W x 27" D  
With Back Shield: 75" H x 36" W x 27"D

DUST TRAY CAPACITY  
450 Cubic Inches

FILTER AREA:  
142 Sq. Feet

### AIR REQUIREMENTS:

- + 1.1 SCFM at 80psi per second of cleaning pulse.
- + Minimum air line is 3/4"
- + Air Pressure regulated 80 – 90 psi.
- + Clean, dry, compressed air at the correct pressure is required for the cleaning system to operate correctly. It is recommended that a pressure regulator and coalescing filter be installed between the compressed air source and the inlet to the table.

## **INSTALLATION:**

### **INSPECTION:**

The MicroAir XA23 is shipped on one skid. This skid should be inspected for any visible damage that may have occurred during shipment. Note any damage on the packing slip.

### **EQUIPMENT/TOOLS REQUIRED:**

- ✦ Standard wrenches.
- ✦ Screwdriver
- ✦ Forklift
- ✦ Pipe Wrench

### **ASSEMBLY OF UNIT:**

Determine the location where the unit is to be installed. Be sure to allow sufficient room around the unit to service the filters, and allow for exhaust air. When selecting a location consider the floor surface. It needs to be smooth and level.

1. Uncrate the unit. Use caution not to damage the paint while dismantling the crate.
2. Remove any options ordered from the skid.
3. Using a forklift, lift the unit off of the skid. Carefully place the downdraft table into its location.

## **COMPRESSED AIR INSTALLATION**

The compressed air inlet for the Roto-Pulse cleaning system is on the left side on the lower-back corner of the unit. A 3/4" air line is required (at a minimum) with 80 – 90 psi clean dry air, for proper operation of the Roto-Pulse® System.

1. Locate the compressed air connection.
2. Connect your standard air fitting to the provided 3/4" NPT thread.
3. Connect your air line to the fitting.

## **ELECTRICAL INSTALLATION:**

**ALL ELECTRICAL WORK MUST BE DONE BY A QUALIFIED ELECTRICIAN ACCORDING TO LOCAL CODES**

**INSTALLATION CAN CAUSE EXPOSURE TO LIVE COMPONENTS. DISCONNECT ELECTRICAL POWER BEFORE PROCEEDING WITH INSTALLATION. PROPER LOCK OUT/TAG OUT PROCEDURES SHOULD BE USED.**

If the unit is ordered with 120V electrical wiring there is no additional wiring required. Simply plug the unit into any 110/120V electrical plug rated for 15A.

**LAMP:** If the unit is ordered with a florescent lamp (optional) that lamp may or may not be wired into the start/stop switch. This is chosen when the unit is ordered. If the lamp is wired into the start/stop it will automatically turn on and off with the unit. If the table is ordered with the lamp unwired, the lamp will need to be wired into some other switch (not provided). Also bulbs are not provided with the unit, they must be supplied by the end user. The fixtures have special dust proof enclosures and require specialty bulbs.

### **UNIT OPERATION:**

1. To start the unit, turn the switch located on the front of the unit to the ON position. To stop the unit, turn the switch to the OFF position.
2. On some units (depending on how the table was ordered) the light may be wired directly into the on/off switch. If this is the case, the light will turn on with the motor. (Bulbs are not supplied with the unit and must be purchased separately.)

## CARTRIDGE CLEANING OPERATION:

The Micro-Air® eXtreme Air Downdraft Table is designed with the Roto-Pulse® Cleaning System to clean the cartridge filters. This system provides superior cleaning performance using a rotating tube with pre-drilled holes. As the diaphragm valve opens, the Roto-Pulse® tube rotates while air exits the holes, thus providing the cleaning of the cartridge.

- For proper cleaning, the compressed air pressure should be regulated at 80 - 90 psi maximum.
- The XA23 is equipped with a manual cleaning system. The filters are cleaned by depressing the button located on the front of the unit near the ON/OFF switch.
- The Roto-Pulse® cleaning operation dislodges particles from the cartridges. Particles then fall down into the collector.

NOTE: When servicing the collection system, be sure to turn the unit off.

NOTE: If less cleaning is needed you should increase the time between manual pulses as means of reducing the amount of cleaning. If more cleaning is needed you should decrease the amount of time between pulses. Beware, as the time between pulses is decreased for additional cleaning, this will increase your compressed air consumption and create an additional load on your compressed air system.

NOTE: Cleaning of the filters too often will decrease your level of performance. A certain level of dust cake on the filters will improve the efficiency of the filter cartridges. You should try to maintain a minimum of 1 in w.c. of pressure differential across the filters. If you can not maintain this minimum level of differential across the filters the time between cleaning pulses should be increased until this can be achieved.

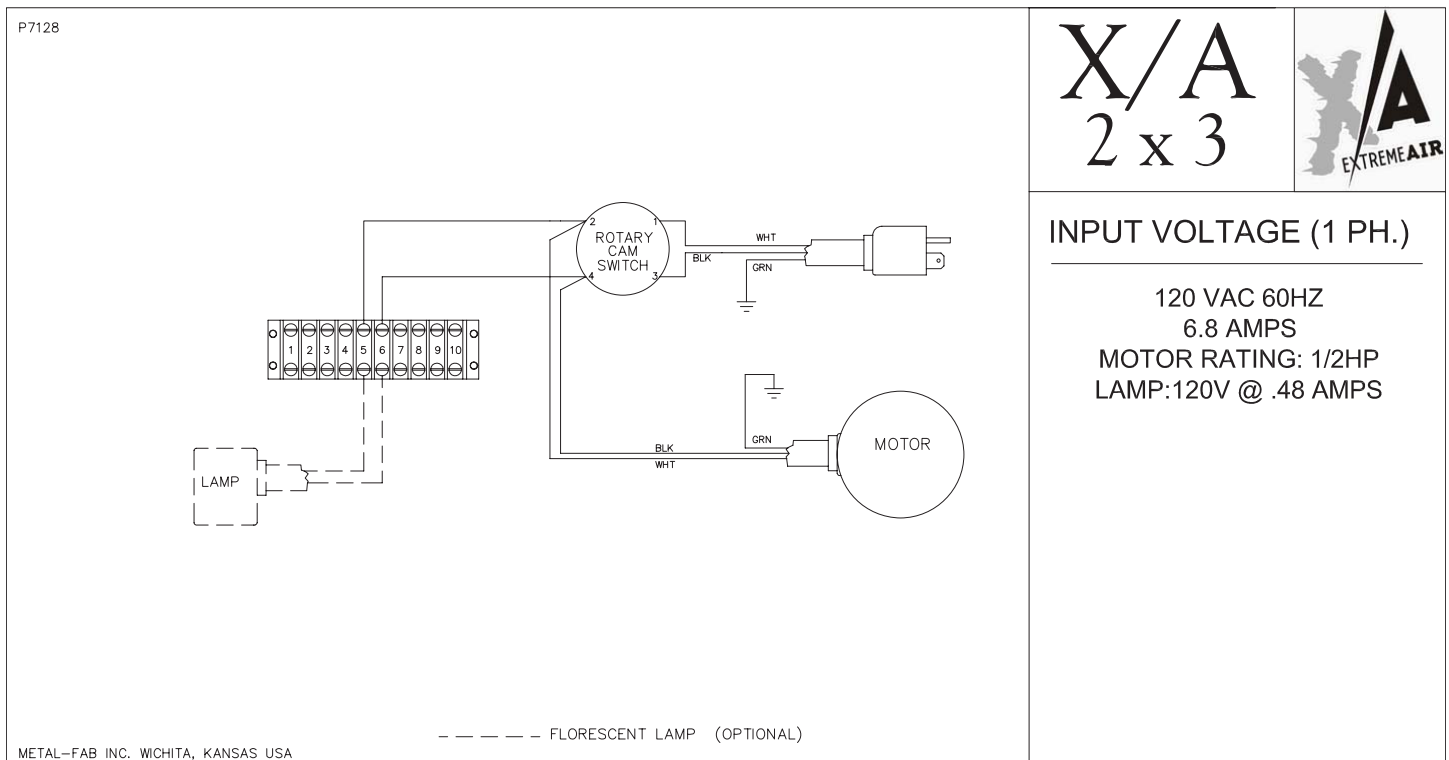

**120V Wiring Diagram**

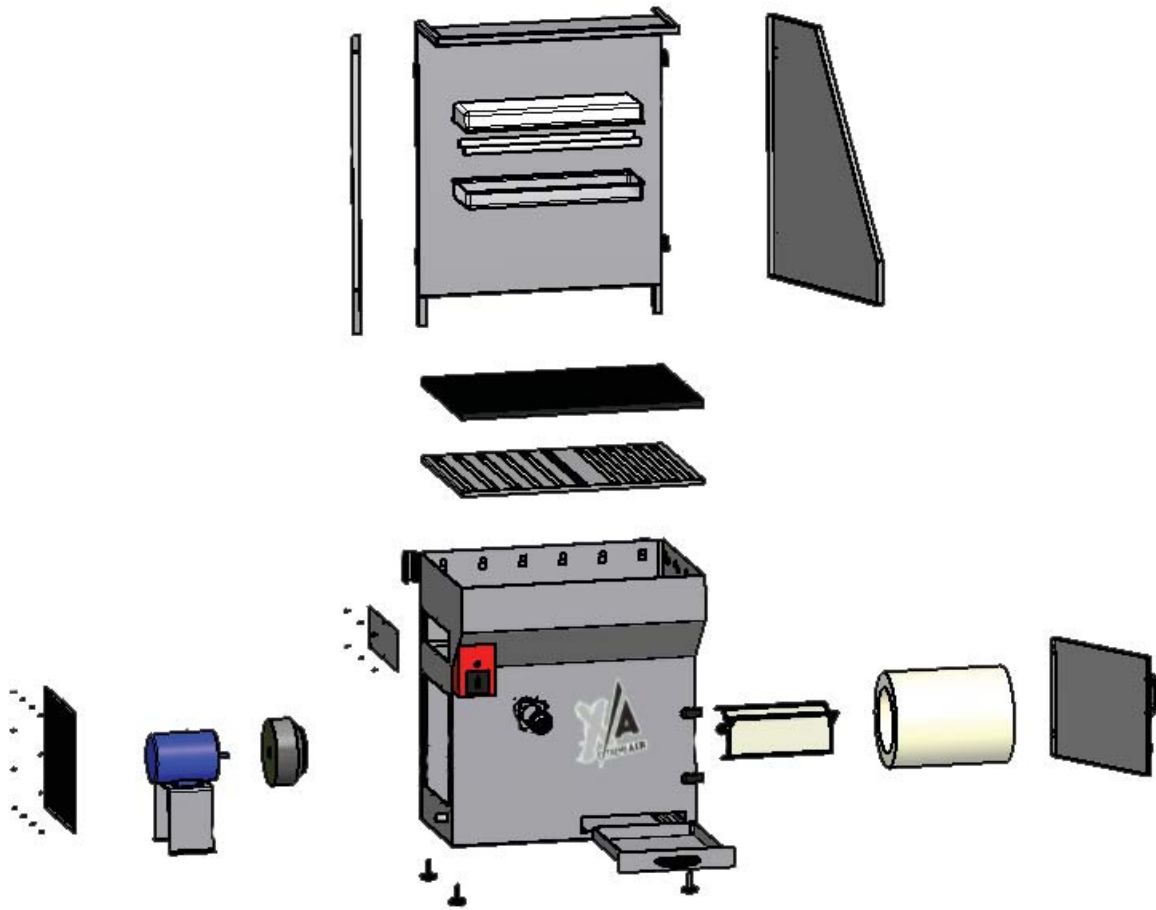

<u>Part No.</u>	<u>Description</u>
P1719	Edge Guard
P2221	Guage
P2334	Caster
p2766	Pulse Button
P3163	Electrical Cord
P3559	Ruber Seal Washer
P3649	Knob
P3735	Presto Lock
P7102	Adjustable Leg
P7106	Latch
P7107	Latch Clasp
P7108	Handle
P7110	On/Off Switch
P7112	Lamp Fixture
P7121	Motor
P7123	Impeller
P7402RM	80/20 Filter
P7407RM	Poly Filter